

GH 24-8 #2

State Well Report

Part 1

Mississippi Department of Environmental Quality
Office of Land and Water Resources
P.O. Box 10631
Jackson, MS 39289-0631
(601)961-5210
(601)354-6938 (fax)

For Office Use Only:

Aquifer: _____
Well #: A-105
L. S. Elevation: _____
E-log #: _____

County: Jeff Davis
Permit #: _____
Driller: John W Thompson
Date drilling completed: 4-28-08

State Law requires that this report be prepared by the driller in detail and filed with the Department within 30 days of completion of drilling of the well.

Well Owner Information	Well Location
Owner Name: <u>Virgil B. Berry</u>	Latitude: <u>31° 44' 03"</u> Longitude: <u>89° 51' 32"</u>
Mailing Address: <u>45 Berry Trail</u> <u>New Hebron, MS 39140</u>	Method of Lat/Long (circle one): <u>Conventional Survey</u> USGS quad, Hand-held GPS, Survey-grade GPS
City: _____ State: _____ Zip Code: _____	<u>SE 1/4 NE 1/4 Sec 24 Twn 9N Rng 19W</u>
Telephone No. () _____	Distance _____ Miles _____ Direction _____ of _____ Nearest Town _____

Well Data

Purpose of Well (circle one) Home Industrial Public Supply Irrigation Fish Culture Other: rig supply

Date well drilling started: 4-28-08 Date well drilling completed: 4-28-08

If flowing, method of flow regulation: Valve _____ Other (describe) _____

Static Water Level: 97 feet above or below (circle one) land surface Date measured: 4-28-08

Method of Measurement (circle one) steel tape electric tape air line other: _____

Hole depth: 193 Well depth: 180 Well grouted to a depth of 20 feet

Type of grout (circle one): Cement Bentonite Mix

Casing length: 160 feet Casing diameter: 4 inches Type of casing: PVC

Screen length: 20 feet Screen diameter: 4 inches Type of screen: PVC Slotted

Screen slot size: .020 inches Setting depth: From 160 feet to 180 feet

Type of completion (circle all applicable): Gravel packed Underreamed Telescoped Open hole Natural Development

Other (describe): _____

Top of lap pipe or reduction in casing: _____ feet. If telescoped or more than one screen, describe on back of page

Logs run (circle all applicable): No log run Electric Gamma Ray Density Sonic Neutron Other: _____

Name of organization running log(s): _____

I certify that the well was drilled, constructed, and completed in accordance with all applicable requirements of the Mississippi Department of Environmental Quality and/or the Mississippi Department of Health regulations and state laws.

John W Thompson 0-679
Print Name of Water Well Contractor and License No.

John W Thompson
Signature of Water Well Contractor

RECEIVED

MAY 27 2008

BY: OLWR

If well telescopes please sketch below and show depths.

Ground Level

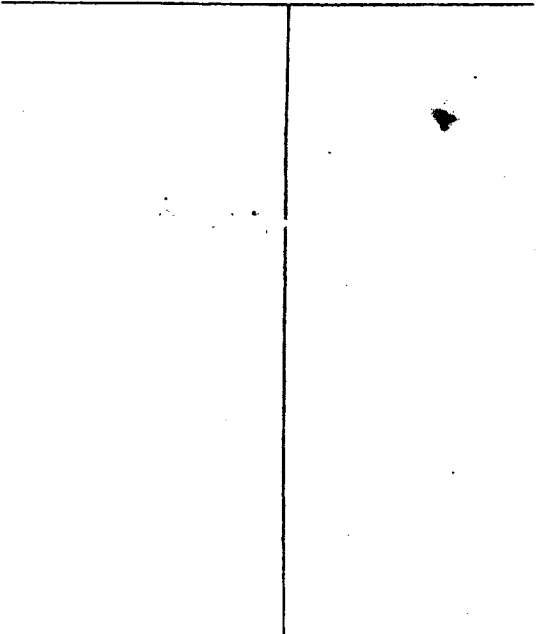

Description of Formations Encountered	From	To
sand & pea gravel	0	80
clay / gravel	80	100
sand	100	160
sand & pea gravel	160	193

more than one screen, show location of each on sketch

Sketch the property layout and include the following: 1) the well location; 2) any permanent structures on the property that may aid in locating the well; 3) any roads, power lines, or other items that may aid in locating the property and the well; 4) indicate direction.

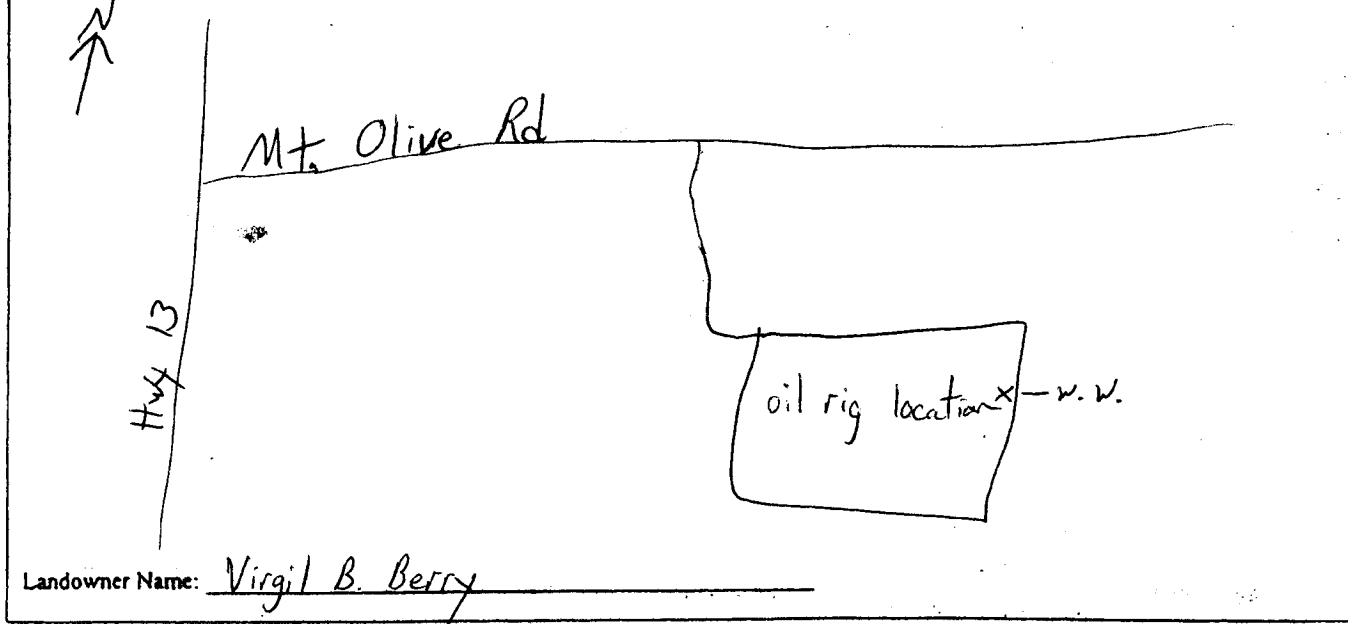

John W. Thompson

 Signature of Water Well Contractor

STATE WELL REPORT

Part 2

Pump Installer's Completion Report
 Mississippi Department of Environmental Quality
 Office of Land and Water Resources
 P.O. Box 10631
 Jackson, MS 39289-0631
 (601)961-5210
 (601)354-6938 (fax)

County: Jeff Davis
 Permit #: _____
 Driller: John W Thompson
 Date completed: 4-28-08
Copy information from block on Part 1

For Office Use Only:

Aquifer: _____
 Well #: A-105
 Elevation: _____

This part of the report must be completed by a licensed water well contractor or a licensed pump installer. A copy of Part 1 of the report must be attached and both parts filed with the Department at the above address within 30 days of well completion.

Well Owner Information	Well Location
Owner Name: <u>Vigil B. Berry</u>	Latitude: _____ Longitude: _____
Mailing Address: <u>45 Berry Trail</u>	Method of Lat/Long (check one): Conventional Survey _____
<u>New Hebron, MS 39140</u>	USGS quad _____, Hand-held GPS _____, Survey-grade GPS _____
City _____ State _____ Zip Code _____	_____ 1/4 _____ 1/4 Sec <u>24 T 9N R 19W</u>
Telephone No. (____) _____	Distance _____ Direction _____ Nearest Town _____
	<u>9</u> Miles <u>N</u> of <u>Prentiss</u>

Pump Type Circle one	Power Type Circle one
Air Lift <input type="checkbox"/> Jet <input type="checkbox"/> <u>Submersible</u>	Diesel Engine <input type="checkbox"/> Gasoline Engine <input type="checkbox"/> Natural Gas <input type="checkbox"/>
Bucket <input type="checkbox"/> Piston <input type="checkbox"/> Turbine <input type="checkbox"/>	<u>Electric Motor</u> <input type="checkbox"/> Hand <input type="checkbox"/> Tractor PTO <input type="checkbox"/>
Centrifugal <input type="checkbox"/> Rotary <input type="checkbox"/> Flowing Well <input type="checkbox"/>	Windmill <input type="checkbox"/> Other (specify): _____
Other (specify): _____	Horse Power Rating of Motor: <u>7 1/2</u>
Date Pump Installed: <u>4-28-08</u>	Setting Depth: <u>140</u> feet
Rated Pump Capacity: <u>85</u> Gallons Per Minute	Number of Stages: _____

Pump Test Data	Method of Measuring Water Level Circle one
Date Well Tested: <u>4-28-08</u>	Air Line <input type="checkbox"/> <u>Electric Measuring Line</u> <input type="checkbox"/> Steel Tape <input type="checkbox"/>
Static Water Level (A): <u>97</u> Feet Below Land Surface	Other (specify): _____
Pumping Water Level (B): <u>105</u> Feet Below Land Surface	For flowing well, measured shut in head: _____ feet
Drawdown [(B) - (A)]: <u>8</u> Feet Below Land Surface	Well yielded <u>100</u> GPM with a drawdown of
Test Pumping Rate: <u>100</u> Gallons Per Minute	<u>8</u> feet after <u>4</u> hours of pumping
Duration of Pump Test (minimum 4 hours): <u>4</u> hours	

I HEREBY CERTIFY that the above statements are true to the best of my knowledge.

John W Thompson 0-679 John W Thompson
 Print Name of Pump Installer and License No. (if applicable) Signature of Pump Installer

Form: OLWR-SWR-1B

RECEIVED

MAY 27 2008

BY: OLWR